



OMNI EZ HD TVI

 **KEZ-c2RICS**

1080p HD Over Regular Coax or UTP
True Day/Night Box Camera
D-WDR, OSD with UTC, Dual Voltage

1080p HD Over Regular Coax or UTP
True Day/Night Box Camera
D-WDR, OSD with UTC, Dual Voltage



1080p

True Day/Night

Digital WDR

3D DNR

BLC HLC

DC12 Dual Voltage AC24V

DC Lens Support

OSD/UTC Up The Cable Control

CVBS Out

Technical Specifications:

Imaging Device	1/2.8" Sony 2.1Mp Progressive Scan CMOS
Video Format	Main Output : 1080p30/25, 720p/30/25 HD-TVI (OSD selectable) Secondary Output : CVBS (OSD selectable NTSC/PAL) service video test point
Actual/Effective Picture Elements	2000 (H) x 1121 (V) / 1984 (H) x 1105 (V)
Maximum Video Output Resolution	1920 (H) x 1080 (V) / 1080p @ 30/25
Sensitivity	.1 lux color, .07 lux B/W (F=1.0)
Day/Night Type	Digital Day/Night
Lens Type	CS Type (C-mount with included adapter) DC iris support
Video Output Connector Type	TVI and CVBS : BNC 75Ω
Sync. Mode	Internal
OSD Menu	Multiple functions using 5 button controls on rear of housing; UTC Control
OSD Languages	English, Spanish, Portuguese, German, Russian, Japanese, French
UTC Control	Full OSD Menu access via up-the-cable (Coaxitron® type) signaling
DWDR / BLC / HLC	OFF/WDR/BLC/HLC Selectable Adjustable for Level 1~10; also BLC area, HLC color.
Auto Gain Control	OFF; 2~42dB
Electronic Shutter	Auto; FLK; or Manual 1/30 (25) to 1/30,000
White Balance	Auto / Push Lock / Auto EXT / Manual
Color Correction	Gamma 0.45~.65, adjustable
Day & Night	True D/N with motorized IR cut filter Optional color-only and B/W only modes under OSD control
Digital Slow Shutter (DSS)	DSS low light boost Off/Auto 2X~16X*
3D-DNR	Off/Low/Mid/High
Digital Zoom	1X~8X
Defog	Off/Low/Mid/High
Mirror	Off / H-flip, V-flip, HV flip (rotate)
Motion Detection	Off/On for programmable zone with sensitivity adjust (pixel change detection)
Privacy Mask	Off/On with full programmability for 8 selectable zones
Lens Shading Compensation	Off/Low/Mid/High
DPC (Defective Pixel Correction)	Off/On
Other OSD Functions	Camera Title with position; Image Sharpness
Power Source	12VDC/24VAC
Power Consumption	12VDC:240mA / 24VAC:3.4W max.
Operating Temperature	14°F~122°F ; -10°C~50°C
Storage Temperature	-4°F~140°F ; -20°C~60°C
Humidity	Less than 80% non-condensing
Dimensions	2.28" x 2.28" x 4.77" / 58mm x 58mm x 121.4mm (includes BNC at rear)
Weight	0.485 lb / 220g
Certifications	CE / FCC
Warranty	3 years

Features

- Superlative HD resolution of 1080p Full HD or 720p HD for amazing image quality and useful digital zoom on live view and playback
 - Field select 1080p or 720p
 - Field select 30/25 FPS
- Operation over 'almost any' wire
 - More than 1000 feet on standard RG59 coax
 - More than 1500 feet on RG6
 - More than 500 feet on UTP (one pair from a Cat5e cable, using optional KA-HDBAL passive balun pair).
- HD-TVI HD BNC main output
- CVBS analog service video output on rear
 - Use standard hand held test monitors
 - Convenient aim and focus; ease of service
- 1/2.8" Sony progressive scan CMOS sensor with .07 lux native light sensitivity
- Flexible choice of Megapixel lens focal length to capture the desired field of view
- Supports both manual or DC iris lenses
- True Day/Night low light operation plus Digital Slow Shutter low light enhancement (More than 2~4X DSS should be limited to select applications.)
- Simple and easy to use OSD setup menu
 - Local 5-button menu control on rear cover
 - Up-the-cable control from OMNI EZHD recorders (or other compatible Coaxitron® control equipment)
 - Digital Wide Dynamic Range to handle the most challenging of bright or unbalanced lighting conditions
 - Programmable Back Light Compensation (BLC) and High Light Compensation (HLC)
 - Adjustable 3D Noise Reduction to increase low light picture clarity and conserve DVR HDD disk space
 - Privacy masking for 8 configurable zones
 - Lens shading compensation for even exposure out to the lens periphery
 - Defog improves image contrast in the presence of haze or smoke that obscures image details
 - Image H/V flip and rotate, digital zoom and more
- Dual voltage 24VAC/12VDC operation with low current draw
- Choice of black or silver housing (2 models) to blend or contrast with the décor
- Standard 1/4-20 attachment points top and bottom for mounting flexibility in our out of a an optional protective housing

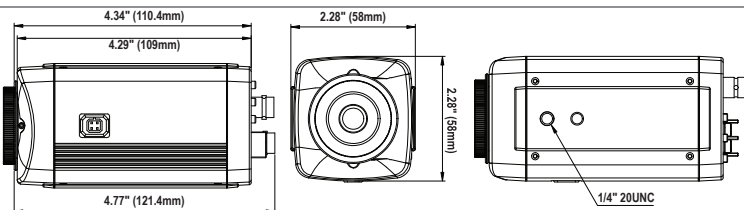

*DSS levels above 4X should be used only after careful consideration of scene dynamics
KT&C America reserves the right to make changes to improve our products at any time without notice; we are not responsible for misprints.